



**Chapter Road  
London, NW2 5LJ**

**£1,585 Per Calendar Month**

Regal estates are pleased to present this two bedroom ground floor garden flat in Willesden.

This flat comprises of two bedrooms, three piece bathroom suite, large separate kitchen, reception and own private garden.

Located just off Willesden High Street it is close to local amenities and walking distance to Willesden Green (Jubilee line, zone 2) and Dollis Hill (Jubilee line, zone 3) underground stations.

Available now.

## Chapter Road, London, NW2 5LJ

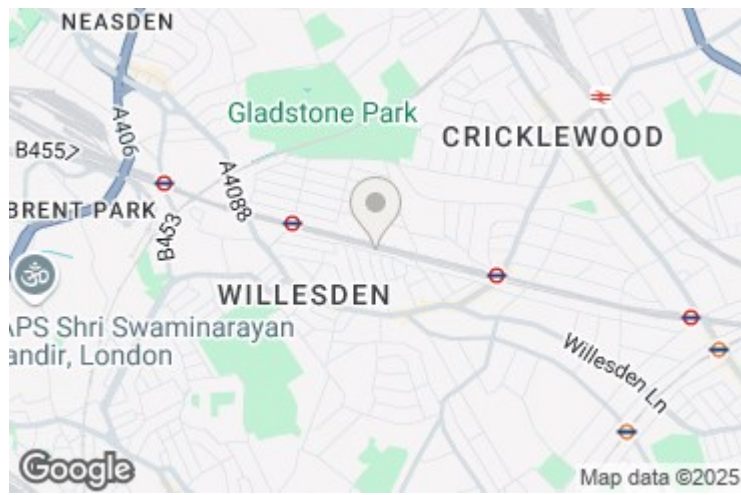

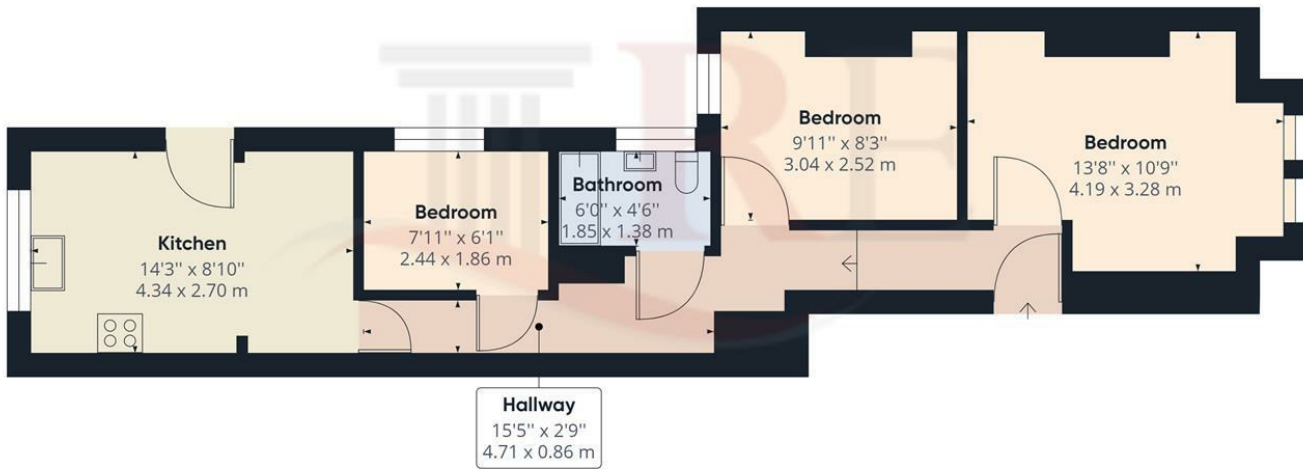

**Approximate total area<sup>(1)</sup>**  
 512.46 ft<sup>2</sup>  
 47.61 m<sup>2</sup>

(1) Excluding balconies and terraces

While every attempt has been made to ensure accuracy, all measurements are approximate, not to scale. This floor plan is for illustrative purposes only.

GIRAFFE360

